

The drawings, information and data recorded in this document ("the information") is the property of Paul Basham Associates. This document and the information are solely for the use of the authorised recipient and this document may not be used, copied or reproduced in whole or part for any purposes other than which it was supplied by Paul Basham Associates. Paul Basham Associates makes no representation, undertakes no duty and accepts no responsibilities to any third party who may use or rely upon this document or the information.

GENERAL NOTES

1. THIS DRAWING IS INTENDED TO BE READ IN CONJUNCTION WITH ALL RELEVANT ARCHITECTS, ENGINEERS, SERVICES AND SPECIALIST DRAWINGS, DETAILS AND SPECIFICATIONS.
2. ANY VARIATIONS OR DISCREPANCIES BETWEEN THESE DRAWINGS IN TERMS OF DIMENSIONS OR DETAILS SHOULD BE DRAWN TO THE ATTENTION OF THE ARCHITECT AND/OR THE ENGINEER FOR CLARIFICATION.
3. ALL FIGURED DIMENSIONS TO BE TAKEN IN PREFERENCE TO SCALED DIMENSIONS. DO NOT SCALE THIS DRAWING.
4. PAUL BASHAM ASSOCIATES ACCEPTS NO RESPONSIBILITY FOR THE ACCURACY OF BACKGROUND INFORMATION PRODUCED BY THIRD PARTIES – THIS MUST BE TREATED AS INDICATIVE ONLY. THIRD PARTY PLANS ARE INCLUDED AS PER THE FOLLOWING:
 - 4.1. Topographical Survey
 - 4.2. Site Layout
5. THIS DRAWING SHOULD ONLY BE USED FOR CONSTRUCTION IF THE PROJECT PHASE IN THE TITLE FRAME BELOW IS SHOWN AS "CONSTRUCTION". PAUL BASHAM ASSOCIATES TAKE NO RESPONSIBILITY FOR CONSTRUCTION WORKS UNDERTAKEN TO DRAWINGS WHICH ARE NOT MARKED UNDER THIS PHASE.

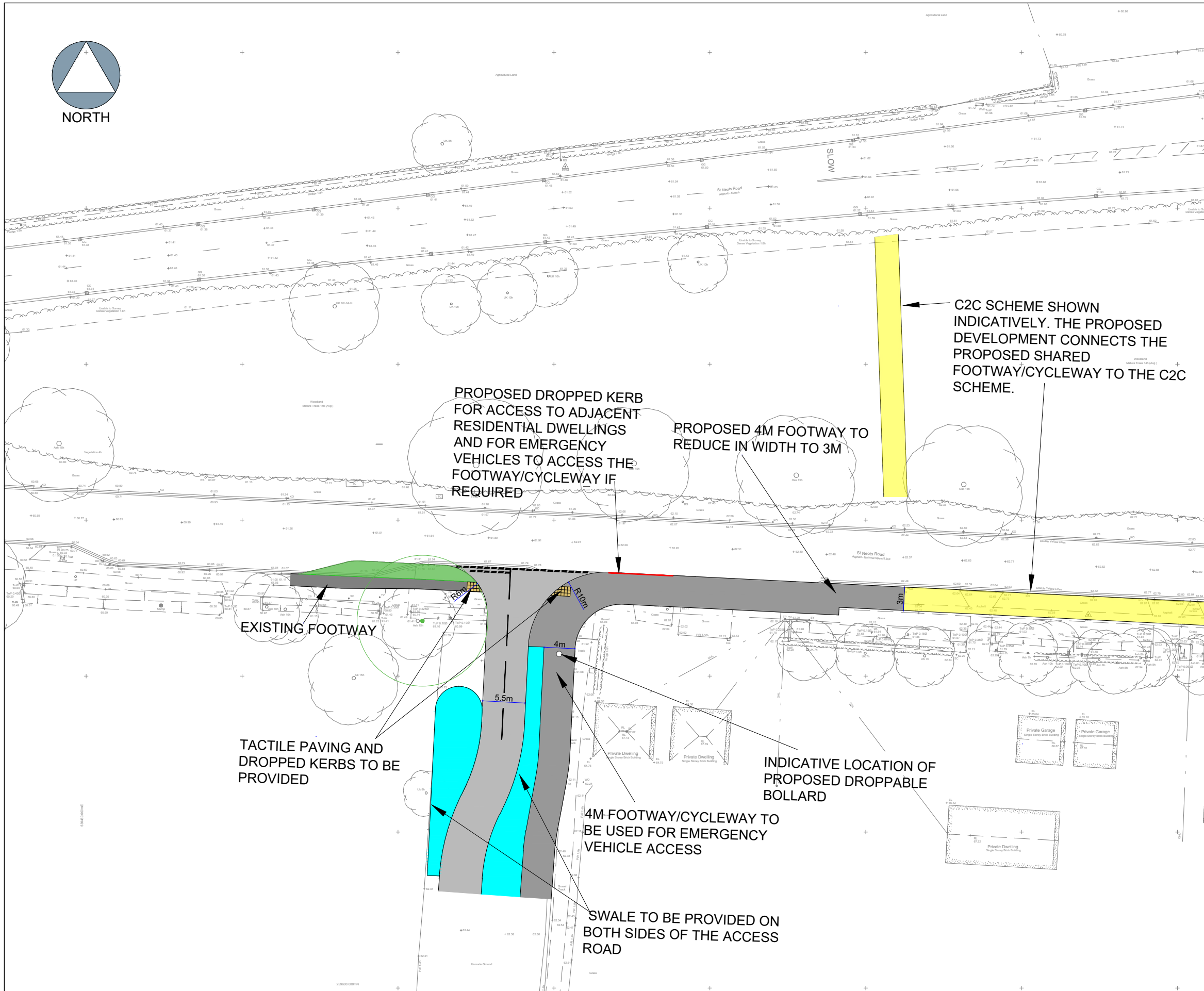

PROPOSED C2C SCHEME FOOTWAY/CYCLEWAY



PRELIMINARY
DRAWING/DESIGN IS STILL 'IN DEVELOPMENT'
YOU ARE ADVISED TO MAKE DUE ALLOWANCE



Rev	Description	Date	By	App'd
P05	CLIENT COMMENTS	09.01.26	AGC	CEC
P04	CLIENT COMMENTS	22.10.25	AGC	WJF
P03	CLIENT COMMENTS	20.10.25	AGC	CEC
P02	SECOND ISSUE	01.09.25	AGC	CEC

Project Name
LAND SOUTH OF ST NEOTS ROAD

Project Phase
PRELIMINARY

Title
PROPOSED SITE ACCESS ARRANGEMENTS



Date Created 01.09.25	Drawn By AGC	Approved By CEC	Suitability Code -
PBA Project Number 1031.0005		Scale 1:500	(AT A3)
PBA Drawing No: 1031.0005 - 0001			Revision P05