

**Slate Hall Industrial Estate
Huntingdon Road, Lolworth, CB23 8HB**

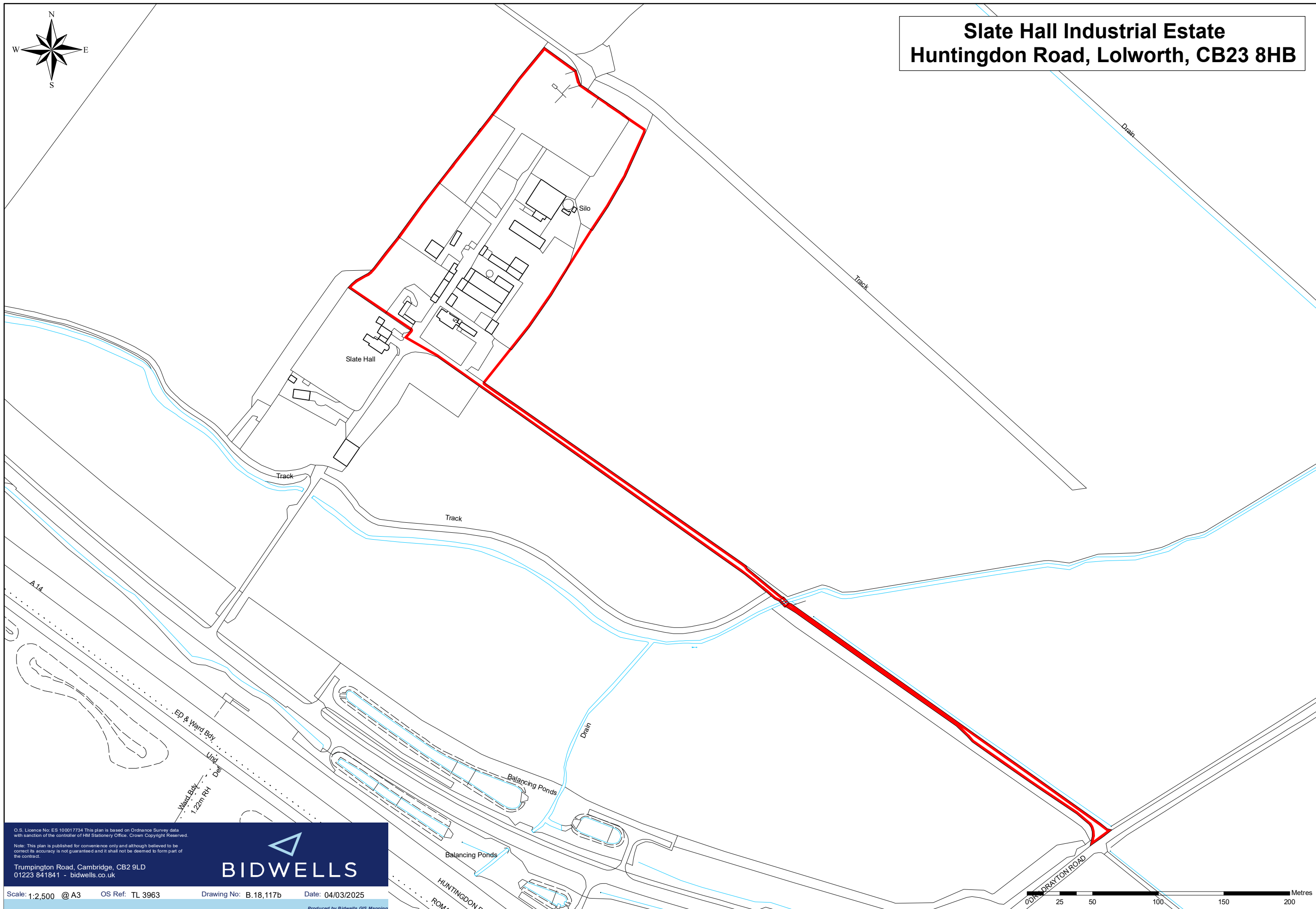

O.S. Licence No: ES 100017734 This plan is based on Ordnance Survey data with sanction of the controller of HM Stationery Office. Crown Copyright Reserved.
Note: This plan is published for convenience only and although believed to be correct its accuracy is not guaranteed and it shall not be deemed to form part of the contract.

Trumpington Road, Cambridge, CB2 9LD
01223 841841 - bidwells.co.uk

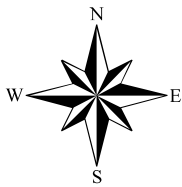

Scale: 1:2,500 @ A3 OS Ref: TL 3963 Drawing No: B.18,117b Date: 04/03/2025

Produced by Bidwells GIS Mapping