

DO NOT SCALE

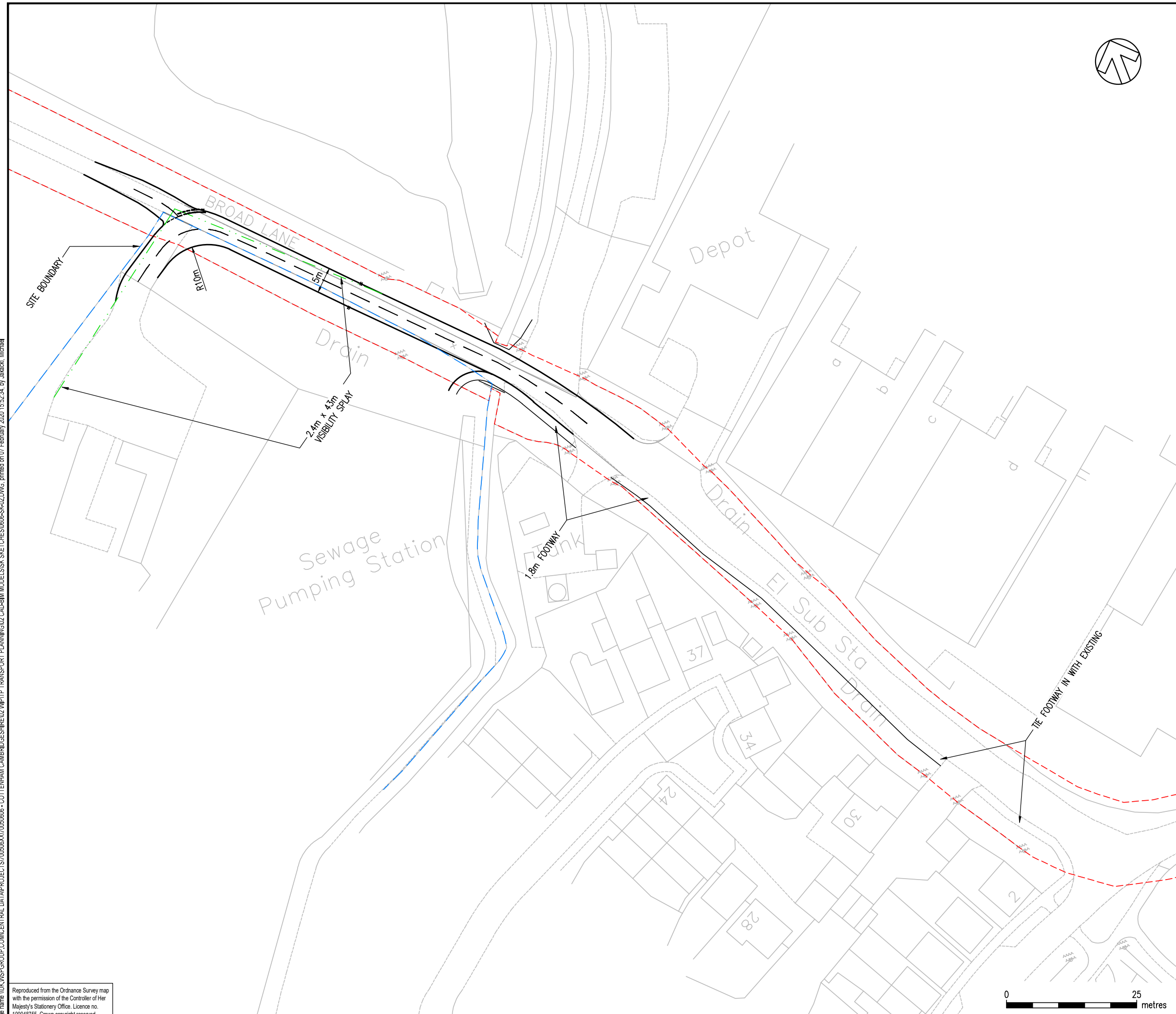

THIS PROVISIONAL PRELIMINARY DESIGN IS FOR GUIDANCE PURPOSES ONLY. WSP ACCEPTS NO LIABILITY FOR ANY DAMAGE, LOSS, EXPENSES OR COST INCURRED AS A RESULT OF RELYING ON THE INFORMATION PROVIDED IN THE DESIGN APPRAISAL ESTIMATE. THE APPRAISAL ESTIMATE WAS DERIVED FROM A MIXTURE OF THIRD PARTY INFORMATION AND THE APPLICATION OF WSP'S REASONABLE SKILL AND CARE, BUT MAY BE SUBJECT TO OTHER SUCH INFORMATION AND VARIATIONS OF WHICH WSP IS UNAWARE. THE DESIGN APPRAISAL ESTIMATE SHOULD NOT BE RELIED UPON FOR TENDER OR PROCUREMENT PURPOSES. FOR ACCURATE ADVICE A DETAILED DESIGN SHOULD BE CARRIED OUT AT THE APPROPRIATE DESIGN STAGE, THEREFORE, USE OF THE INFORMATION IS ENTIRELY AT YOUR OWN RISK.



P01	07/02/2020	JEY	FIRST ISSUE
REV	DATE	BY	DESCRIPTION	CHK	APP

DRAWING STATUS: S0 - WORK IN PROGRESS



Unit 9 The Chase, John Tate Road, Foxholes Business Park, Hertford, SG13 7NN, UK
T+ 44 (0) 1992 526 000, F+ 44 (0) 1992 526 001
wsp.com

CLIENT: SOUTHERN & REGIONAL DEVELOPMENTS LTD

ARCHITECT: --

PROJECT: BROAD LANE, COTTENHAM

TITLE: NEW ROAD LAYOUT

SCALE @ A2: 1:1000	CHECKED: MPJ	APPROVED: MPJ
PROJECT No:	DESIGNED: JEY	DRAWN: JEY
		DATE: February 20

DRAWING No: 0606-SK-02	REV: P01
---------------------------	-------------

© WSP UK Ltd

File name: \\UK\WSPGROUP\PROJECTS\0606\0606-0606-COTTENHAM-CAMBRIDGE\0606-SK-02.DWG, printed on 07 February 2020 15:52:34, by: Jacek, Michael

Reproduced from the Ordnance Survey map with the permission of the Controller of Her Majesty's Stationery Office. Licence no. 100048755. Crown copyright reserved.