

HM Land Registry
Official copy of
title plan

Title number **CB425340**
Ordnance Survey map reference **TL4066SW**
Scale **1:1250** enlarged from **1:2500**
Administrative area **Cambridgeshire: South**
Cambridgeshire

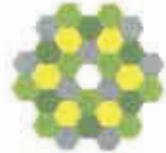

© Crown copyright and database rights 2017 Ordnance Survey 100026316
You are not permitted to copy, re-broadcast, distribute or sell any of this data to third parties in any form.

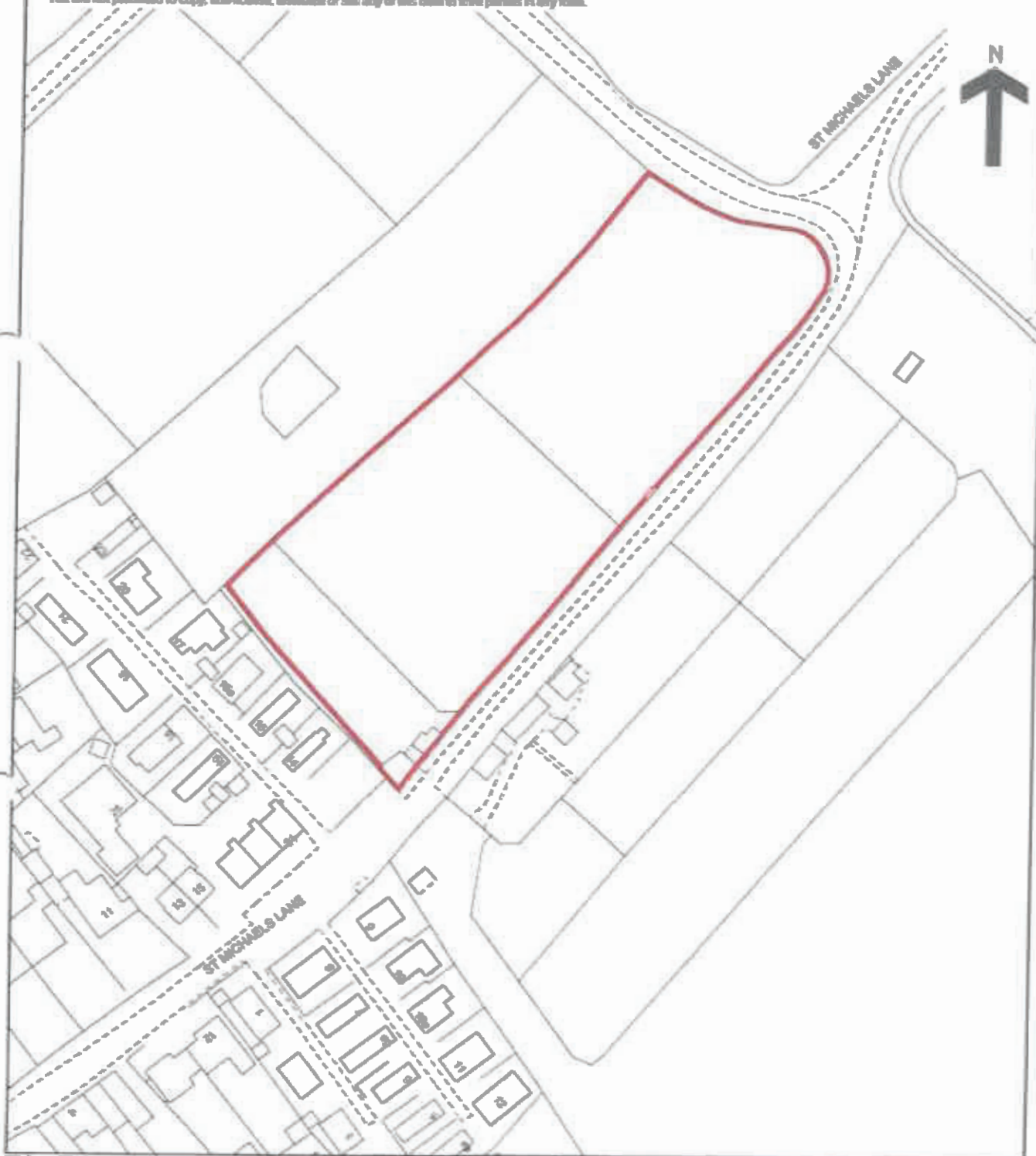

**This official copy issued on 14 December 2017 shows the state of this title plan on 14 December 2017 at 14:06:41.
It is admissible in evidence to the same extent as the original (s.67 Land Registration Act 2002).
This title plan shows the general position, not the exact line, of the boundaries. It may be subject to distortions in scale.
Measurements scaled from this plan may not match measurements between the same points on the ground.
This title is dealt with by HM Land Registry, Peterborough Office.**